

ADAPT™ MODULE

WARNING!

Before removal or installation of your SurgeX™ ADAPT™ Module, first remove the magazine and check the chamber of the firearm to confirm that it's in a safe condition and completely unloaded. Failure to do so could result in serious personal injury or death.

WARNING!

Never attempt to remove a hot suppressor without the proper protective gear. Allow the suppressor to cool before removal. Failure to do so could result in personal injury or death.

REMOVAL



Step 1/3

To remove the ADAPT Module, first remove the muzzle cap from the end of the Module using the supplied tool. This is accomplished by inserting the grooves of the tool into the corresponding grooves in the muzzle cap and rotating the tool counter-clockwise until removed.

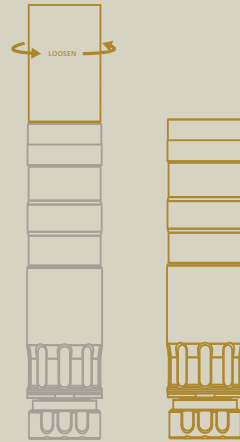

Step 2/3

With the muzzle cap removed, hold the suppressor body with one hand and rotate the Module counter-clockwise until removed.



Step 3/3

With the Module removed you can now thread the muzzle cap onto the suppressor body until it's hand tight.

SERVICE/MAINTENANCE

WARNING!

Never attempt to clean a suppressor while it's attached to a host weapon, as this could lead to personal injury or death.

WARNING!

Always wear proper protective equipment while performing service/maintenance. Failure to do so could result in personal injury or death.

WARNING!

Before performing service/maintenance on the muzzle device, remove the magazine and check the chamber of the host weapon to confirm that it's in a safe condition and completely unloaded. Failure to do so could result in serious personal injury or death.

Due to the construction and use of exotic materials, the SurgeX™ requires limited service/maintenance. It is important to keep all the mounting threads clean and free from debris.

1. This can be accomplished with a small amount of gun cleaning solvent and a brush.
2. All solvent should be fully removed from the suppressor prior to use. This can be accomplished with hot soapy water taking care to let the suppressor fully drain before use. The use of compressed air is highly recommended.

WARNING!

It is the operator's responsibility to check the bore of the suppressor to confirm that it's free of debris/obstructions. This should be performed before any use and after all maintenance cycles. Failure to do so could result in serious personal injury or death.

CONCENTRICITY

It is imperative that the host weapon's threads are concentric to the bore. This ensures there is no misalignment between the bore and the suppressor. If you are unsure about the quality of the threads on your rifle, have it checked by a qualified gunsmith.

AMMUNITION

Rugged Suppressors recommends that only quality factory loaded ammunition of the correct grain weight be used. It is up to the operator to determine the correct projectile/barrel twist to ensure proper stabilization in the host weapon.

WARNING!

Discharging firearms in poorly ventilated area, cleaning suppressors and handling ammunition could result in exposure to lead, a substance known to cause birth defects, reproductive harm, cancer and other serious physical injury. Always have adequate ventilation at all times and wash your hands thoroughly after exposure.

WARNING!

While suppressors reduce the sound impulse of a gun shot they do not eliminate the impulse all together. It is still necessary for the shooter and any bystanders to wear OSHA approved hearing protection when exposed to impulses over 85db.

SURGE X™

BELT-FED RATED® 7.62 SUPPRESSOR

OPERATOR'S MANUAL

** WARNING **

Read the operator's manual in its entirety before use. Failure to follow all operating instructions, assembly and disassembly, installation, cleaning and maintenance instructions before using the suppressor could result in serious injury or death. If you are at all unsure about any of the operations or instructions outlined in the operator's manual, STOP and CONTACT US for further clarification.



UNCONDITIONAL LIFETIME WARRANTY

IF FOR ANY REASON YOU HAVE AN ISSUE WITH A RUGGED SUPPRESSORS PRODUCT, WE WILL REPAIR OR REPLACE IT FREE OF CHARGE.



VISIT US AT RUGGEDSUPPRESSORS.COM
864-810-0513 | INFO@RUGGEDSUPPRESSORS.COM

MADE IN USA

REV-06-02-24



MUZZLE DEVICE INSTALLATION

SEE THE RUGGED SUPPRESSORS' WEBSITE FOR INSTALLATION INSTRUCTIONS.

SURGEX™ COMPONENTS AND TOOLS

1. Front Cap

- Stainless Steel
- Compatible with all Rugged rifle suppressors.
- All other Rugged rifle front caps can be used on the SurgeX™.

2. ADAPT™ Module

- Choose between a long and short configuration for maximum versatility.
- Module installs hand tight.

3. Multi-Tool Retainer

- The Multi-Tool Retainer secures the Multi-Tool within the suppressor core and provides a protective surface to rest the suppressor on while using a vise.
- The retainer is installed **finger tight** which is all that is required to perform its function.
- Finger grooves allow the retainer to be quickly and easily installed/removed.

4. Multi-Tool

- Incorporates a 11/16" Hex.
- This tool has features to tighten and loosen:
 - Front caps (hand tighten)
 - Accessory options (torque spec)
 - Suppressor to mounts (torque spec)
- When reconfiguring the suppressor, place the multi-tool inside the suppressor core and rotate until the tool drops down into the fully seated position.
- **Do not use without retainer!**
- To adjust the mounts or accessories, Rugged recommends placing the suppressor side with the multi-tool into a vise.

5. SurgeX™ Suppressor

- 17-5 PH Stainless Steel body
- Cobalt6 and Stainless Steel baffles
- Belt Fed Rated®
- .30 caliber

6. Rugged Universal Mount (R.U.M.) - Stainless Steel

- Adapts Rugged's Dual Taper Mounting Solution to the SurgeX and other universal threaded suppressors.
- SurgeX comes with the R.U.M. pre-installed to torque specification (25 ft-lb).
- To ensure proper torque is achieved during removal and installation, a bench vise (on the suppressor side) and torque wrench with socket (on the mount side) are recommended.
- In the event of the mount coming lose from the suppressor while on the host firearm, there are two flats on the outer ring that may be **lightly** clamped in a vise or smooth jaw pliers so the collar may be unlocked and allow the mount to be removed from the muzzle device.
- We do **NOT** recommend using the flats to install or remove the mount from the suppressor.
- < LOCK - UNLOCK > markings are engraved on the collar to assist with installation/removal procedures from the host weapon.

7. Dual Taper Adapter Tool

- Incorporates a 3/4" Hex.
- Interfaces with the Rugged Universal Mount (R.U.M.) for installation/removal purposes only.
- The Dual Taper Adapter tool is secured in the mount with its collar locked upon unboxing.
- Unlock the collar and remove the tool before shooting.
- When not in use, store the tool in a safe place -such as the suppressor box.

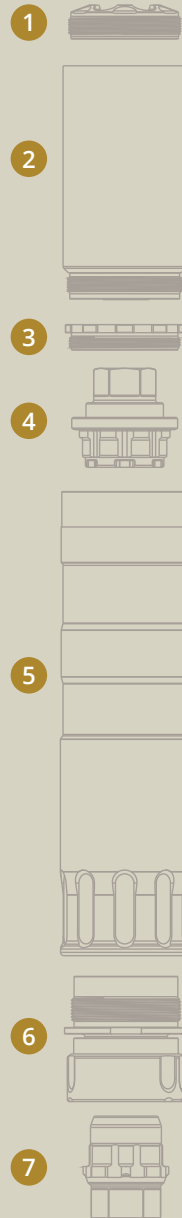

SURGEX™ INSTALLATION

WARNING!

- Before installation of the SurgeX suppressor, remove the magazine and check the chamber of the firearm to confirm that it's in a safe condition and completely unloaded. Failure to do so could result in serious personal injury or death.
- Before installation of the SurgeX suppressor, check the bore of the suppressor to make sure it's free of any obstructions. Failure to do so could result in serious personal injury or death.
- It is important to read the owners manual entirely and follow the following steps to ensure your suppressor is properly mounted prior to shooting. Failure to follow instructions will result in damage to your suppressor.

- To prevent galling and seizing, the suppressor's universal thread is lightly coated with anti-seize. Ensure any time the mount is removed and re-installed, that the threads are clean of debris and anti-seize is present to prevent unnecessary issues.
- The 1.375x24 thread is compatible with other manufacturers mounting options, however, we recommend using Rugged-specific products.
- Interior front cap threads on the suppressor are coated with white lithium grease when shipped. Upon unboxing, the tools may be removed and the front cap installed. It is recommended to apply additional white lithium grease to the front cap threads throughout use as needed.

The Dual Taper Lock™ mount is a friction lock type mount. It utilizes a thread and taper to mount the suppressor, providing concentricity to the rifle bore. The locking collar contains two spring arms that compress on the rear taper of the muzzle device to provide constant spring pressure ensuring that your suppressor stays firmly seated during fire.

Step 1/4

Open the locking collar by twisting it clockwise until it stops. Use the engraved lock/unlock directional arrows engraved on the collar for reference.



Step 2/4

Hold the suppressor by the main body and thread suppressor onto the muzzle device until it is fully seated. **Do not thread on using the locking collar.**

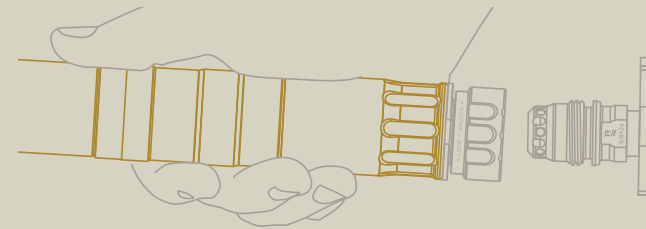

Step 3/4

Turn the locking collar clockwise 1/2 a turn until tight. Use the engraved lock/unlock directional arrows engraved on the collar for reference.

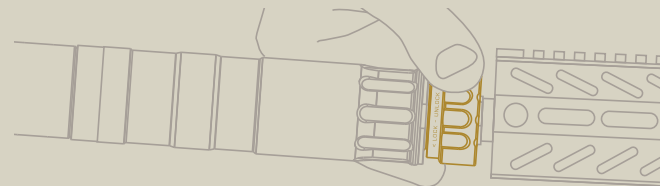

Step 4 /4

Verify suppressor is fully seated via the go gauge on the muzzle device. You should only be able to see "GO" on the muzzle device.

*See Figure A below for details.

DUAL TAPER LOCK™ GO GAUGE INSTRUCTIONS

On the wrench flat of your Dual Taper Lock™ muzzle device is a go gauge to assist you with proper installation of your suppressor. Using the bottom of the lock collar as a visual guide, you will be able to ensure that your suppressor is properly mounted to your host firearm. When properly installed, you will only be able to see "GO" when looking directly at the locking collar on the muzzle device.

FIGURE A

INCORRECT
installation
shown via
NO-GO gauge

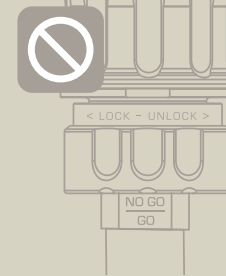

CORRECT
Installation
shown via
GO gauge

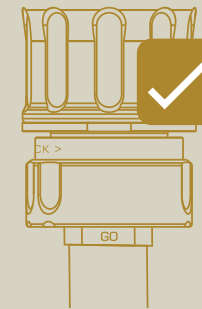

SURGEX™ REMOVAL

WARNING!

- Before removal of your SurgeX suppressor, remove the magazine and check the chamber of the firearm to confirm that it's in a safe condition and completely unloaded. Failure to do so could result in serious personal injury or death.

- Never attempt to remove a hot suppressor without the proper protective gear. Allow the suppressor to cool before removal. Failure to do so could result in personal injury or death.

- Never allow a hot suppressor to come into contact with anything. Allowing a hot suppressor to come in contact with anything could result in fire, personal injury or death.

Step 1/2

Turn the locking collar counter-clockwise a 1/2 rotation; this disengages the rear locking taper.

Step 2/2

With the rear locking collar disengaged, hold the body of the SurgeX and rotate the suppressor counter-clockwise 2.5 turns and slide the suppressor over the muzzle device.